

Damper Mount Linkage Kit

Provides remote inside duct mounting for Bray NR and SR Model actuators. Used on a 3-blade or larger damper. Nominal spring return torque is 100 lb-in at the damper pin.

CONTENTS

Item	Description	Qty	Item	Description	Qty
1	Universal Mounting Bracket	1	12	Lock Washers	2
2	No. 12-24 x 1/2 in. (13 mm) Hex-head,	9	13	Nuts	2
3	Bracket Reinforcement Link	1	14	Shaft Clamp Plug (from the Bray-153	1
4	1/4 in. diameter x 11/32 in. (8.7 mm)	1	15	Bray Crank Arm (from the Bray-153	1
5	Reinforcement Plate (Bray-152)	1	16	Nuts	*
6	Anti-rotation Bracket	*	17	Swivel Ball Joint	1
7	Anti-rotation Bracket Screws	*		Lock Washer	1
8	Long Screws	2		Nut	1
9	Washers (NR Series Only)	2	18	Blade Arm Bracket	1
10	Inserts (NR Series Only)	2	19	Rod Connection Head	1
11	Spacers	2	20	Connection Head Pin	1
			21	Connection Head Clip	1
			22	Rod	1

* Included with the actuator.

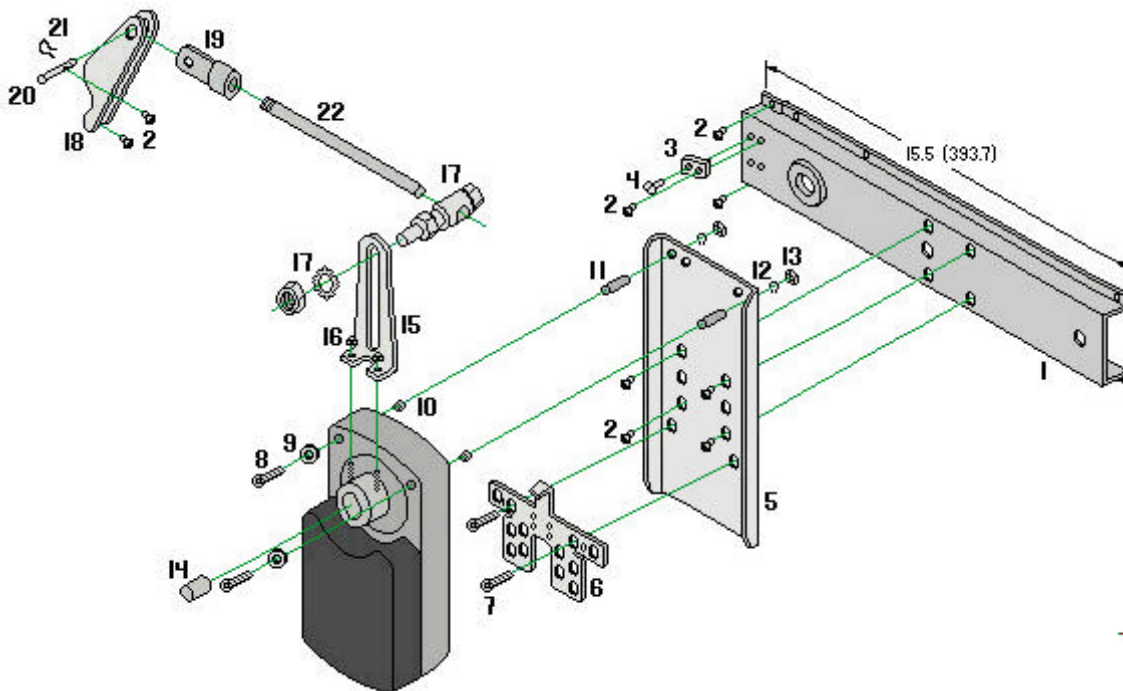

Base Mount Linkage Kit

Provides remote inside duct mounting for NR and SR Model actuators. Used on a 3-blade or larger damper. Nominal spring return torque is 100 lb-in at the damper pin.

CONTENTS

Item	Description	Qty	Item	Description	Qty
1	Upright Mounting Bracket	1	11	Bray Crank Arm (from the Bray-153)	1
2	Anti-rotation Bracket	*	12	Nuts	*
3	Anti-rotation Bracket Screws	*	13	Swivel Ball Joint	1
4	Long Screws	2		Lock Washer	1
5	Washers (NR Series Only)	2		Nut	1
6	Inserts (NR Series Only)	2	14	Blade Arm Bracket	1
7	Spacers	2	15	No. 12-24 x 1/2 in. (13 mm) Hex-head,	2
8	Lock Washers	2	16	Rod Connection Head	1
9	Nuts	2	17	Connection Head Pin	1
10	Shaft Clamp Plug (from the Bray-153)	1	18	Connection Head Clip	1
			19	Rod	1

* Included with the actuator.

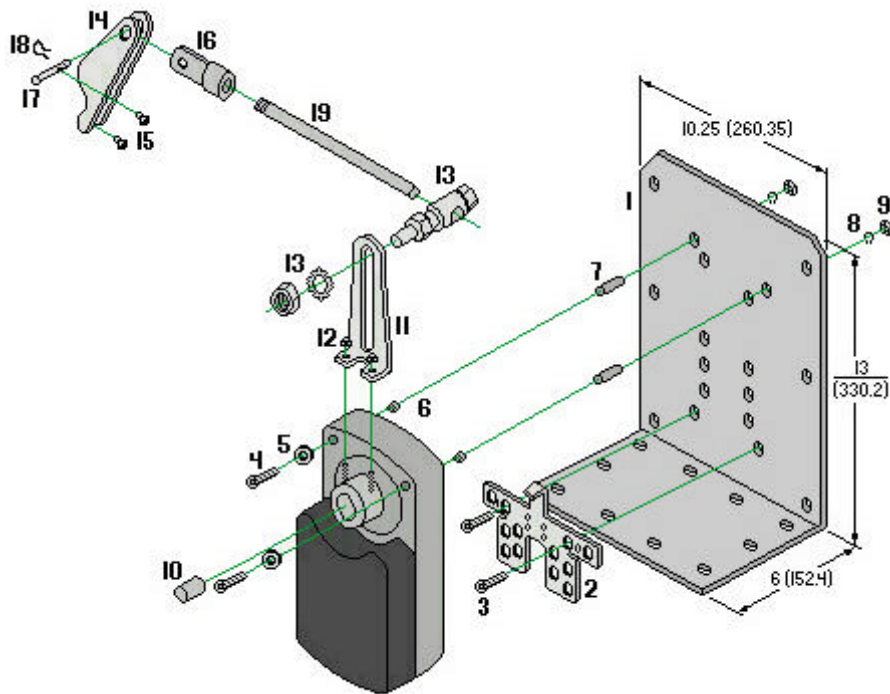

CA Series Accessories

NR / SR Model Kits

Crank Arm Kit

Provides the crank arm and shaft plug for remote mounting the NR and SR Model actuators.

CONTENTS

Item	Description	Qty
1	Shaft Clamp Plug	1
2	Bray Crank Arm	1

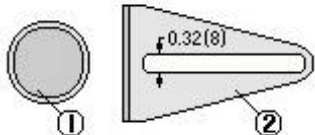

Weathershield Enclosure

Provides additional protection for NR and SR Model actuators that are mounted outdoors. Internal dimensions (H x W x D) are 13.75" x 7.75" x 6" (349.25mm x 196.85mm x 152.40mm)

CONTENTS

Item	Description	Qty
1	Cover	1
2	4-part Case	1
3	Actuator Mounting Plate	1
Included With Kit	No. 6-20 x 1/2 in. Screws	26

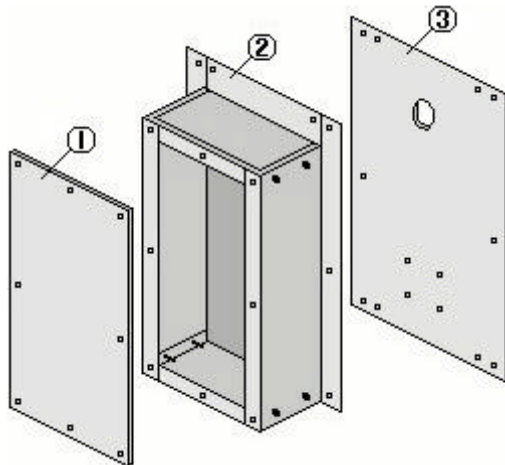

Jackshaft Coupler Kit

The Bray-154 1" Jackshaft Coupler Kit [1.05" (26.7mm) maximum diameter) is for use with the NR-2208, NR 2216, NR-2224 and SR-2216 Model electric motor actuators.

CONTENTS

Item	Description	Qty
1	Coupler	1
2	1.05 in. clamp	1
3	Limit Stop	1
4	Washers	2
5	M6 x 1 Hex Nuts	2
6	Position Indicator	1
7	1.05 in. U-bolt	1
8	Locking Clip	1

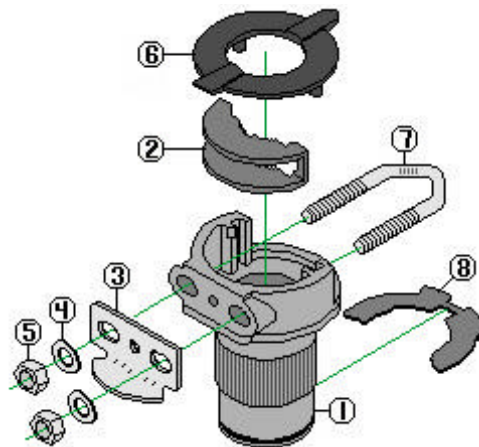

CA Series Accessories

B Model Kits

Floor Mount Kit ASK71.1U

This kit allow foot mounting of the Bray actuators. This kit should be used for in-the-airstream applications, and generally, anywhere a foot-mounted actuator could be mounted.

CONTENTS

Item	Description	Qty
1	Crank Arm	1
2	Support Bearing Ring	1
3	Mounting Bracket	1
4	Fasteners	All Supplied

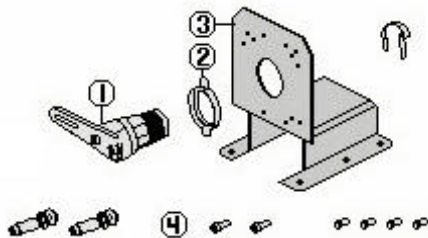

Frame Mount Kit ASK71.2U

This kit allows mounting of the Bray actuators directly to a damper frame. This kit should be used with louvers and vents and in applications where use of the floor mount kit is not pos-

CONTENTS

Item	Description	Qty
1	Crank Arm	1
2	Support Bearing Ring	1
3	Mounting Bracket	1
4	Fasteners	All Supplied

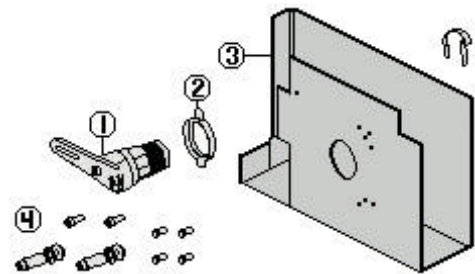

Crank Arm Kit ASK71.3

This kit allows a direct coupled actuator to provide an auxiliary linear drive. This crank arm kit can be used to simultaneously drive a set of opposing or adjacent dampers with a single actuator.

CONTENTS

Item	Description	Qty
1	Crank Arm	1
2	Fasteners	All Supplied

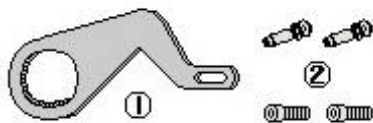



CA Series Accessories

B Model Kits

Crank Arm Kit with Mounting Bracket ASK71.4

This kit allows economical mounting of a Bray actuator to a variety of surfaces. This kit should be used in applications where the actuator can be rigidly surface mounted and a linear stroke output is required.

CONTENTS

Item	Description	Qty
1	Crank Arm	1
2	Mounting Bracket	1
3	Fasteners	All Supplied

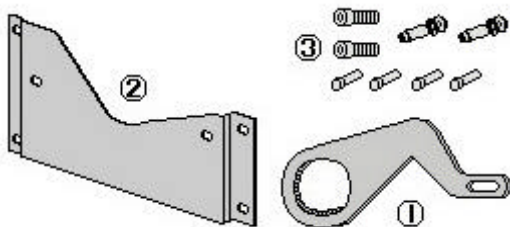

Tandem Mount Bracket ASK73.1

This bracket provides an extended anti-rotation pin that allows two B Model Bray actuators to directly drive a single damper shaft. For use with two and three-position actuators.

CONTENTS

Item	Description	Qty
1	Tandem Mount Bracket	1
2	Fasteners	All Supplied

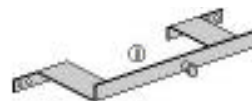

Crank Arm Kit with Mounting Bracket ASK74.1

This shaft adapter will attach to a 1.05" (26.6mm) diameter shaft, whereas, the standard self-centering adapter will accept up to a 1.00" (25.4mm) diameter shaft. This special adapter can be used for coupling to 1" jackshafts that are slightly oversized.

BCA/BBB: 3/8 to 1.05" (9.5 to 26.6mm) shaft sizes.
BIB: for >3/4" (19mm) shaft sizes.

CONTENTS

Item	Description	Qty
1	Shaft Adapter	1
2	Fasteners	All Supplied

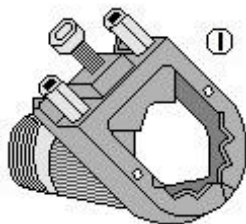

Bray[®] CONTROLS

Commercial Division

A Division of BRAY INTERNATIONAL, Inc.
13333 Westland East Blvd. Houston, TX. 77041
Toll Free: 888.412.BRAY (2729), Fax: 888.412.2720 www.bray.com
©1999 Bray International. All rights reserved. B-1-2 9/99
Bray[®] is a registered trademark of BRAY INTERNATIONAL, Inc.

All statements, technical information, and recommendations in this bulletin are for general use only. Consult Bray representatives or factory for the specific requirements and material selection for your intended application. The right to change or modify product design or product without prior notice is reserved.